



**FAUCET GROUP**

J-1176-R

**CONCEALED LEDGEMOUNT FAUCET5**

**SUBMITTAL DATA**

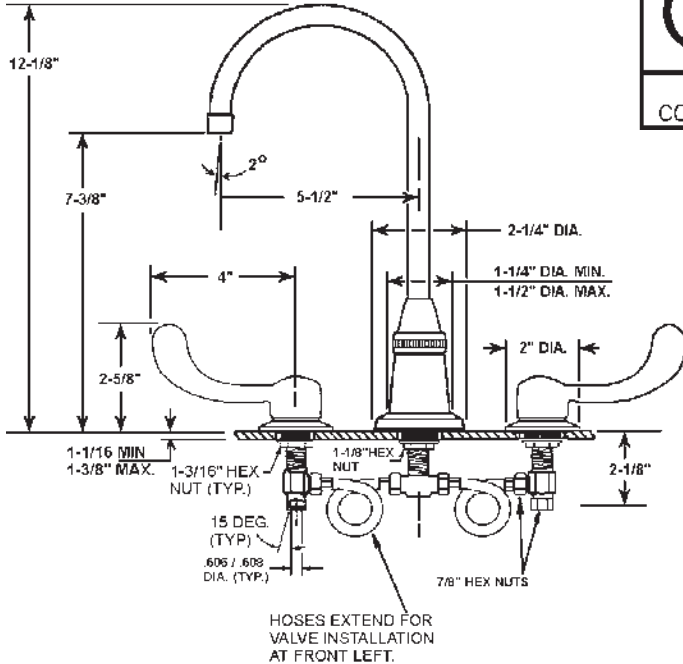

**TECHNICAL DATA CONSTRUCTION:**

- Concealed ledgemount on installer defined centers
- Controls & spout are connected by reinforced nylon hose
- Cast brass bodies
- Rigid gooseneck spout with 7-3/8" clearance
- Replaceable seats
- Brass quarter turn quick stem units
- Replaceable reinforced nitrile rubber packing
- Replaceable Buna-N seat washers
- 4" PVD chrome wrist blade handles
- Equipped with water saving aerator
- Conforms to ANSI standard 112.18.1
- Certified by IAPMO R&T to:
  - \* NSF/ANSI 61/9- Annex G
  - \* AB1953 Compliant

**OPTIONS**

**AERATOR**

- Duo Stream Swivel "B"
- Rose Spray "J-RS"

**FINISH**

PVD chrome

**FLOW RATE**

2.2 GPM flow restricting aerator

**A.D.A. COMPLIANCE**

Yes

**VARIANTS**

J-1176-KS = w/ swivel spout

FUNCTIONAL DESIGN, QUALITY, AND SPECIFICATIONS LISTED DESCRIBE THE JUST STANDARD OF QUALITY. WHEN MAKING COMPARISONS WITH OTHER OFFERINGS, INSIST ON THE JUST QUALITY OF CONSTRUCTION. FOR ADDITIONAL INFORMATION REGARDING THE COMPLETE LINE OF JUST SINKS, FAUCETS AND DRAINS, VISIT OUR WEB SITE AT [www.justmfg.com](http://www.justmfg.com)

Job Name _____	
Customer _____	
Architect/Engineer _____	
APPROVED FOR MANUFACTURING	
MODEL NO. _____	QTY. _____
COMPANY _____	
TITLE _____	DATE _____
SIGNATURE _____	

Dimensions may vary and are subject to change.  
No responsibility is assumed for use of superseded or voided data.

<b>JUST MANUFACTURING COMPANY</b>	
9233 KING STREET . FRANKLIN PARK . ILLINOIS . 60131-2111	
PH: 847-678-5150 . FAX: 847-678-6817	
E-MAIL: <a href="mailto:custserv@justmfg.com">custserv@justmfg.com</a> . <a href="http://www.justmfg.com">www.justmfg.com</a>	



**FAUCET GROUP**

**CONCEALED LEDGEMOUNT FAUCET**

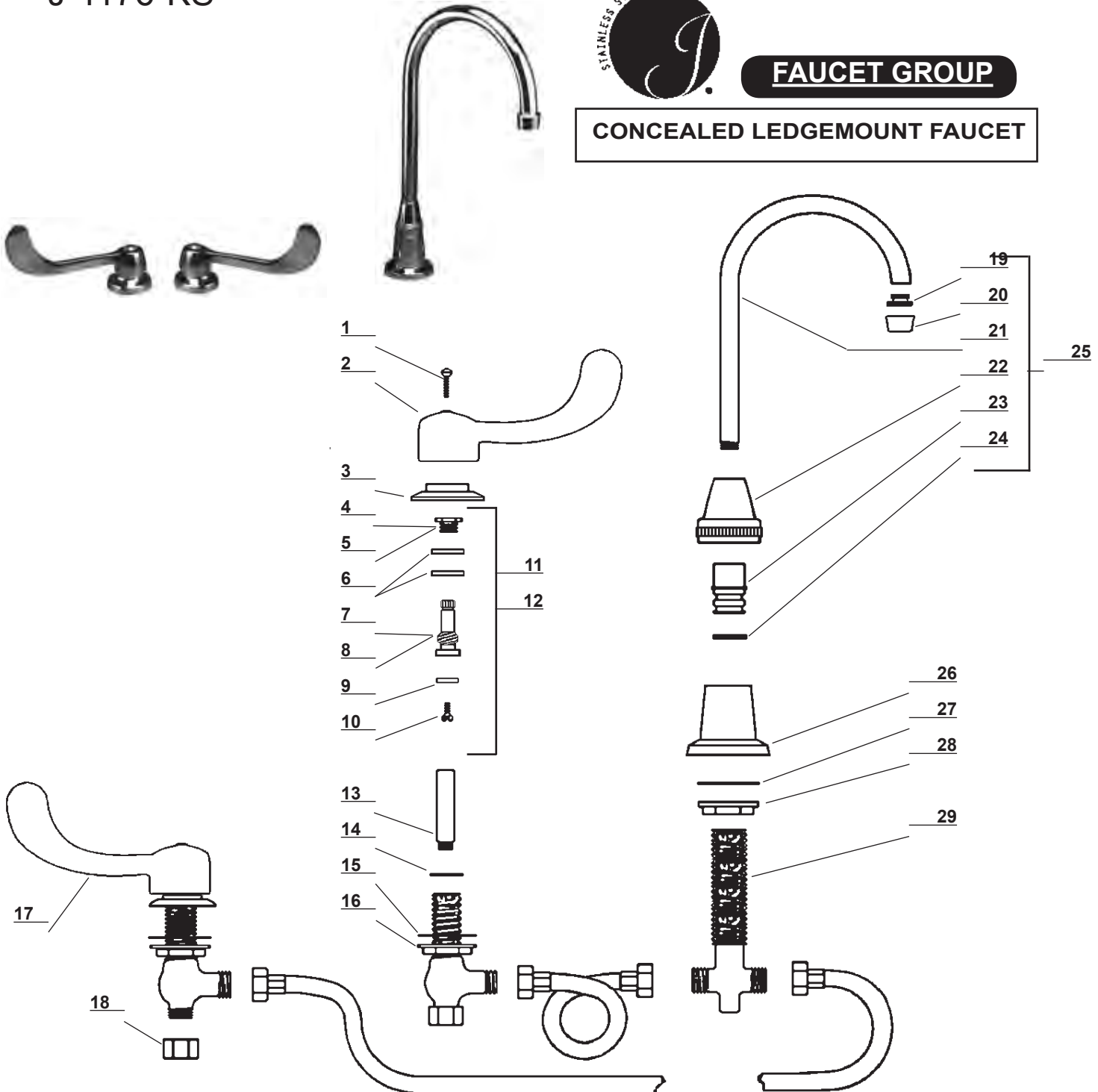

Item No.	Part No.	Description
1	107-H	Handle Screw
2	4147	Blade Handle - 4"
3	PF-524-J	Escutcheon
4	454-EWC	Bonnet ( Cold Side )
5	454-EWH	Bonnet ( Hot Side )
6	1038-453	"O" Ring
7	454-FL	Stem ( Cold Side )
8	454-FR	Stem ( Hot Side )
9	901-WN	Seat Washer
10	104	Seat Washer Screw
11	SU-454-EL	Stem Sub-assembly (Cold)
12	SU-454-ER	Stem Sub-assembly (Hot)
13	263-C	Replaceable Seat
14	1028-Y	Gasket
15	491-U	Gasket
16	53-AS	Locknut

Item No.	Part No.	Description
16	53-AS	Locknut
17	4147	Blade Handle - 4"
18	4015	Coupling nut
19	PF-166-U	Adapter
20	30-M	Aerator
21	PF-157-K	Gooseneck spout
22	PF-157-JES	Spout nut
23	PF-741-DO	Adapter
24	1038-K	"O" Rings
25	SU-157-R	Gooseneck spout assembly
26	1012N	Escutcheon
27	491-S	Gasket
28	4090-SKO-3	Locknut
29	2971	Tee body