



**ACADEMIC GROUP**



**ADA COMPLIANT**

**SPECIFICATION**

Seamless die-drawn construction of type 304, 18-8 stainless steel. Interior and top surfaces polished to a non-porous Hand-blended Just Finish with high-lighted bowl rim. Fully coated underside insulates for sound, and reduces condensation. Straight-sided compartment with 1 3/4" radius corners provides greater capacity. Self-rimming top mount Grip-Rim Plus with 300 series stainless steel mounting channels. Drain punch #35 centered for Just J-35 unless otherwise specified.

**To be specified :**

**Faucet hole punching:**

- (1) Hole - Left rear
- (1) Hole - Right rear
- (1) Hole Centered
- (2) Holes on 4" centers
- (3) Holes on 4" centers (illustrated)
- Alternate Punching:

Faucet Model: \_\_\_\_\_ Punching required: \_\_\_\_\_

**Bubbler punching:**

- (1) Hole -Right front (illustrated)
- (1) Hole -Left front

**DRAIN LOCATION MUST BE SPECIFIED:**

- CENTER (SHOWN)
- LEFT REAR
- RIGHT REAR
- CENTER REAR

**LOCATIONS MUST BE A MINIMUM OF 4 1/2" FROM THE BOWL WALL.**

MODEL NO.	A	B	C	D	E	CUTOUT*
CRA-ADA-1725-A-GR	17	25	14	16	4-1/2 to 6-1/2	16-1/4 x 24-1/4
CRA-ADA-1923-A-GR	19	23	16	14	4-1/2 to 6-1/2	18-1/4 x 22-1/4
CRA-ADA-1928-A-GR	19	28	16	19	4-1/2 to 6-1/2	18-1/4 x 27-1/4
CRA-ADA-1931-A-GR	19	31	16	22	4-1/2 to 6-1/2	18-1/4 x 30-1/4
CRA-ADA-2225-A-GR	22	25	19	16	4-1/2 to 6-1/2	21-1/4 x 24-1/4

\* Cutout dimensions shown (Front-to-Back) x (Left-to-Right) - Corners of cutout may be square or up to 1/2" radius.

FUNCTIONAL DESIGN, QUALITY, AND SPECIFICATIONS LISTED DESCRIBE THE JUST STANDARD OF QUALITY. WHEN MAKING COMPARISONS WITH OTHER OFFERINGS, INSIST ON THE JUST QUALITY OF CONSTRUCTION. FOR ADDITIONAL INFORMATION REGARDING THE COMPLETE LINE OF **JUST** SINKS, FAUCETS AND DRAINS, VISIT OUR WEB SITE AT [www.justmfg.com](http://www.justmfg.com)

Job Name \_\_\_\_\_

Customer \_\_\_\_\_

Architect/Engineer \_\_\_\_\_

**CRA-ADA - SERIES - A - 18 GA.**

**A.D.A. COMPLIANT - CLASSROOM SINKS**

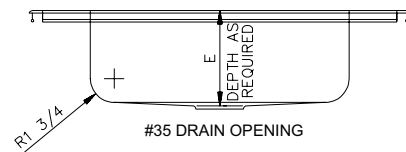
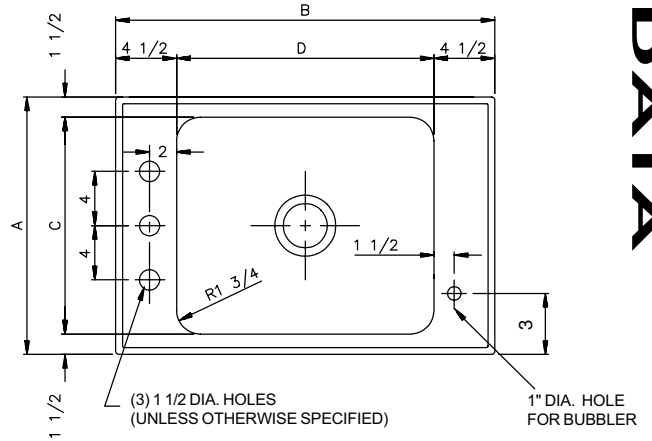
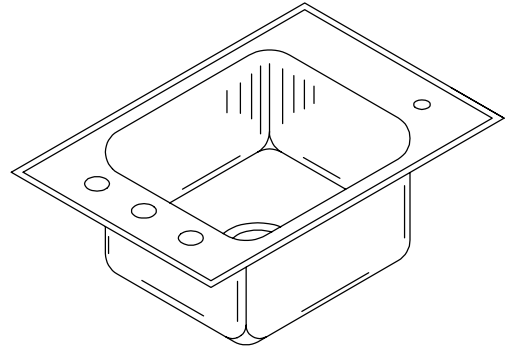

**SUBMITTAL**

**DATA**

**APPROVED FOR MANUFACTURING**

MODEL NO. \_\_\_\_\_ QTY. \_\_\_\_\_

COMPANY \_\_\_\_\_

TITLE \_\_\_\_\_ DATE \_\_\_\_\_

SIGNATURE \_\_\_\_\_

REVISED- 4/2009

**JUST MANUFACTURING COMPANY**

**9233 KING STREET . FRANKLIN PARK . ILLINOIS . 60131-2111**

**PH: 847-678-5150 . FAX: 847-678-6817 . E-MAIL: [custserv@justmfg.com](mailto:custserv@justmfg.com) . [www.justmfg.com](http://www.justmfg.com)**